

# Waterproof 8mm Endoscope Camera for iPhone, iPad, Smartphones, Tablet



## FAQ

### 1. The APP does not produce pictures

- Check whether the mobile phone is connected to the WIFI hotspot of the device
- Check whether the camera light is on. If it is not on, please turn on the OTG function, or because the interface is not in good contact, please plug it in again
- The camera light flashes when showing pictures. Please keep the battery of your phone above 20%

### 2. The imaging picture is not clear

- The optimal imaging focal length of the product is: 2cm-10cm. Please calibrate the distance to the object you are viewing, or clean the front end of the camera with a clean alcohol cloth

### 3. The camera is hot

- It is normal for the camera to heat up, especially when the camera LED light is at its highest brightness, but it does not affect normal use or service life

## Safety and maintenance

- Do not hit the camera violently and do not pull the cable forcefully
- When using in an environment with sharp protrusions, please use it with caution to prevent the waterproof protective layer of the probe from being scratched
- The camera probe is not made of heat-resistant and high-temperature material. When checking the car engine, please ensure that the temperature inside the engine drops to normal temperature
- When not in use, please ensure that the lens and main unit are clean and dry, and avoid contact with oil stains or other corrosive and dangerous items
- This product is not suitable for use by people with limited physical, sensory or mental capabilities
- Please do not let children touch and operate this equipment
- If the equipment is damaged, please do not disassemble it yourself. Contact the place of purchase or agent for maintenance services
- This product is an industrial endoscope inspection camera and is not suitable for medical use or human examination

## Instructions

### Download APP

#### Method 1:

- For IOS users, please search "ANESOK" in the App store, download and install it. System support (iOS9+ and above)
- For Android users, please search "ANESOK" in Google Play Store, download and install it. System support (Android 4.4+ and above)



#### Method 2:

- Scan the QR code, choose to download the App. System support (Android 4.4+, iOS9.0+ and above)



## Device power supply method

1. Mobile phones and tablets directly power the device (supports Type-C/Lightning/Micro)

2. After the device is powered on, the LED light continues to flash

**Note: If there is no power outage, the OTG function needs to be turned on in the phone settings. (Different models of mobile phones have different ways to turn on OTG, please search online to find the method)**

**Reminder: If you use other devices (power bank, PC) for power supply, you need to confirm that the output port is: 5V/1A**

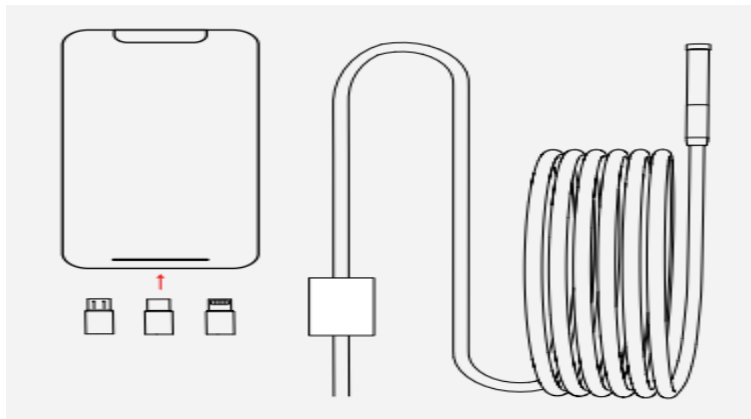

## Connect to Wi-Fi

1. Click the mobile phone: Settings / WLAN, turn on the WLAN switch, select "ANESOK-XXXX" to connect

2. Exit after the connection OK, then open the "ANESOK" App to use

**Note: After the device connected to the mobile phone, the LED light on the device will keep ON**

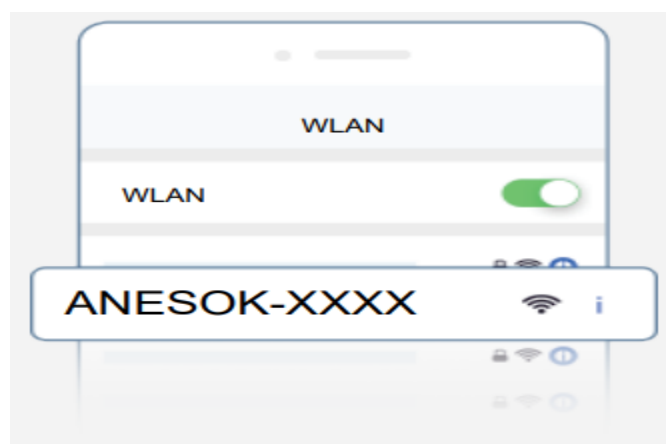

## APP Introduction



1. Settings
2. Enter the picture interface
3. WiFi connection status prompt
4. Enter photo album
5. Adjust screen resolution
6. Return
7. Zoom in (Single lens: Null)
8. Enter photo album
9. Rotate screen
10. Switch between modes: color (black/white)
11. Image comparison
12. LED adjustment
13. Take a photo / Record a video
14. Switch camera (Single lens: Zoom in/out)
15. Photo
16. Generate PDF documents
17. Video

## Accessories installation guide

Accessories and installation diagram:

- Magnet (x1), Hook (x1), Fixing device (x1)

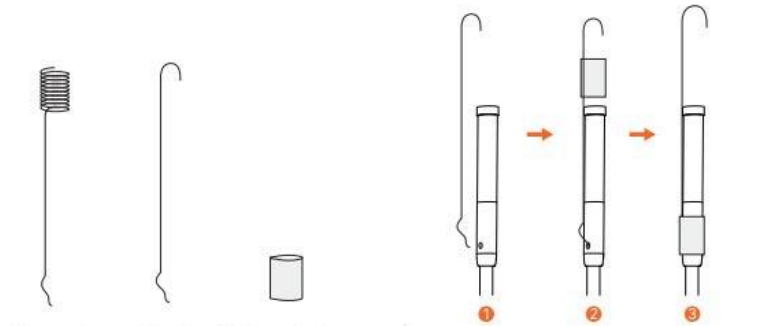

- Dual lens no need side mirror, single lens is equipped with side mirror

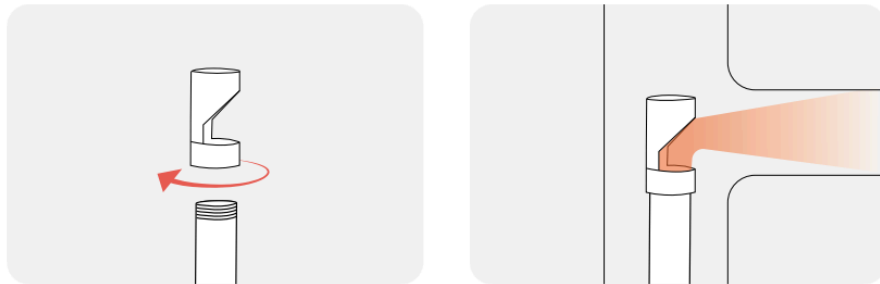

Specifications:

- Product name: Industrial endoscope
- Resolution: 1920x1080
- Sensor: CMOS
- Lumen: 24lm
- Focal length range: 2-10cm
- Waterproof grade: IP67
- Charging: 5V/1A
- Field of view: 70 degrees
- Camera temperature: 33.8-176 degrees
- Working temperature: 33.8-113F