

A1 Tuya WiFi Fingerprint Smart Door Lock with Dynamic Passwords and NFC

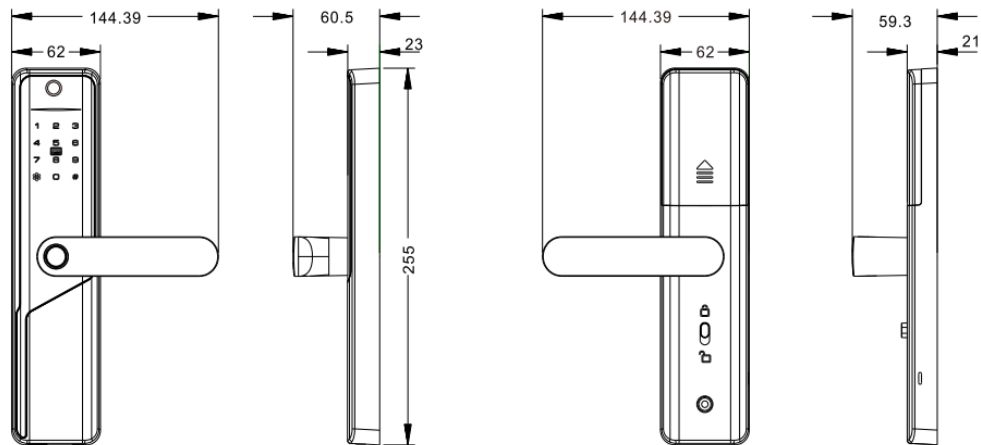

Dimensions (mm)



Explanatory diagram

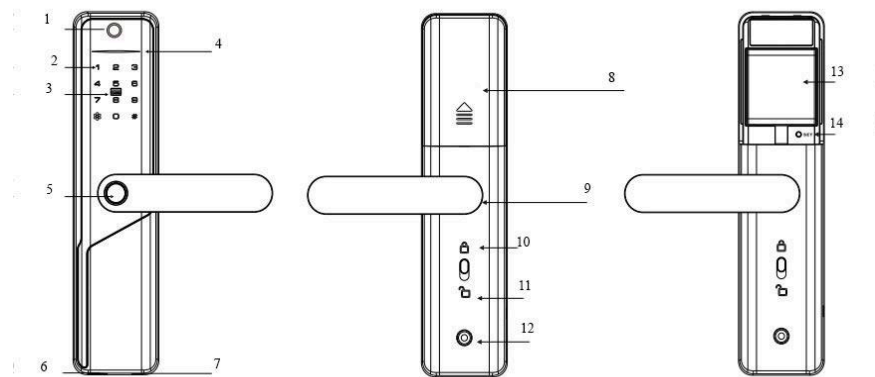

1. Camera
2. Password
3. Magnetic card
4. Lamp
5. Fingerprint
6. Keyhole
7. USB
8. Battery cover
9. Handle
10. Internal locking
11. Internal unlocking
12. Screw hole
13. Battery
14. Reboot system

Installation diagram

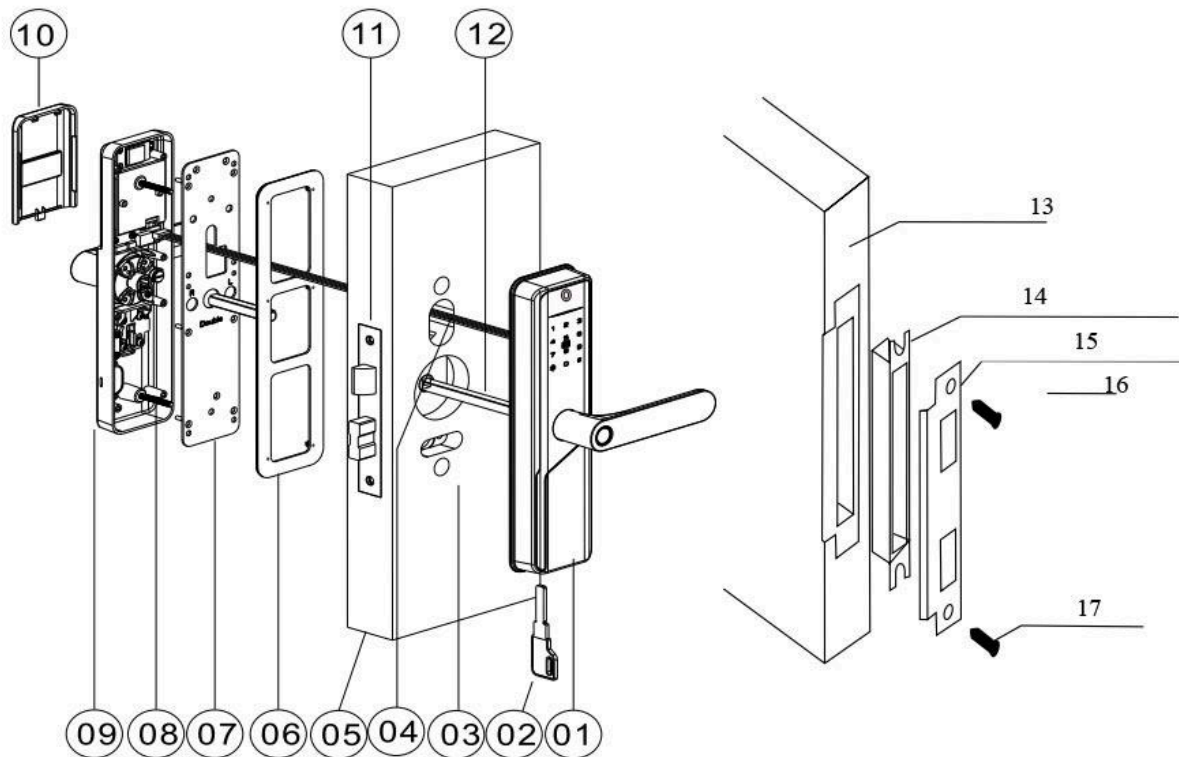

1. Front lock
2. The key
3. Fix column
4. Connecting line
5. The door
6. Silicone pad
7. Iron plate
8. Set screw
9. Rear lock
10. Battery cover
11. Lock body
12. Square shaft
13. Door frame
14. Lock tongue box
15. Locking tongue
16. Baffle
17. Set screw

Installation steps

Lock body direction adjustment

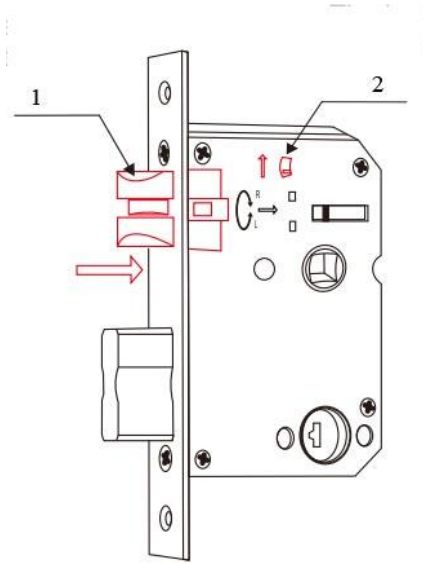

1. The lock tongue is ejected and rotated by 180 degrees and pressed back
2. The buckle is lifted and the locking tongue pops up

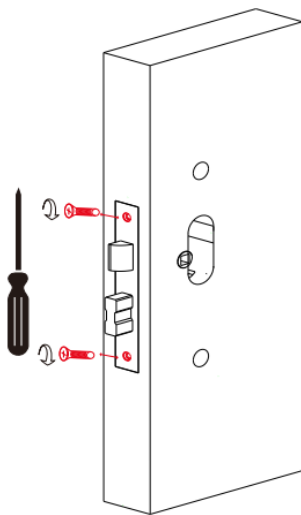

Fixed lock body

Handle reversing diagram

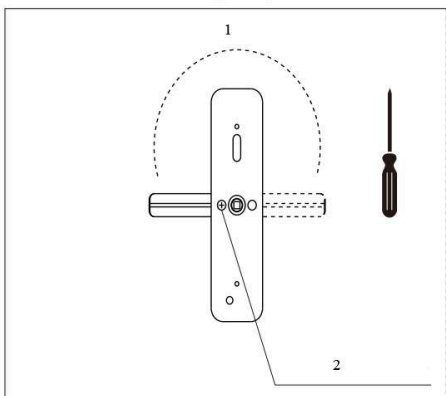

Front lock

1. Rotate the handle by 180 degrees and fix the screw
2. Remove the screws and rotate the handle

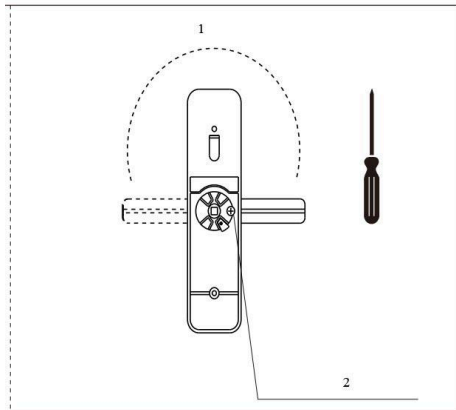

Rear lock

1. Rotate the handle by 180 degrees and fix the screw
2. Remove the screws and rotate the handle

Install the connecting posts

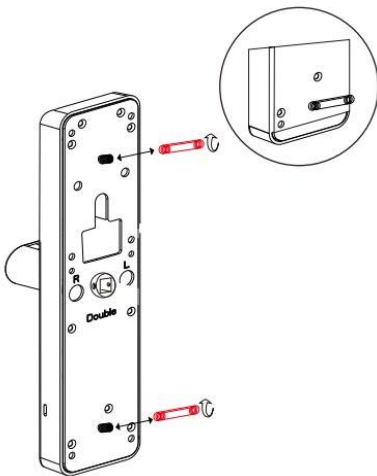

Install the square rod and fixing pin

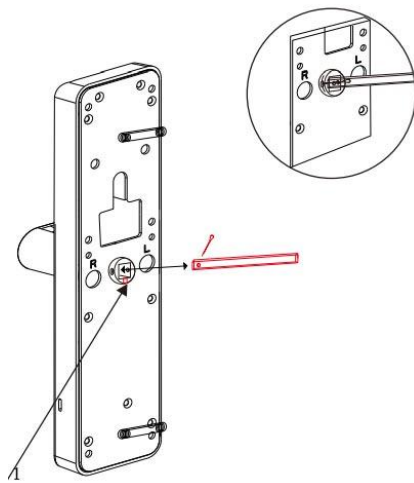

1

Notice this dimension point

- Single tongue lock body. The front lock handle points to R on the right side
- Sing tongue lock body with front lock handle punctuated to L on the left side
- Double tongue lock body, the marked point of the front lock handle points to double

Install the front and rear panel non-slipmat

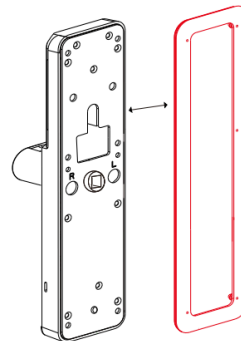
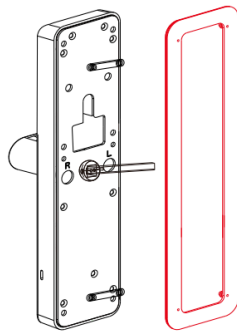

Install the front panel

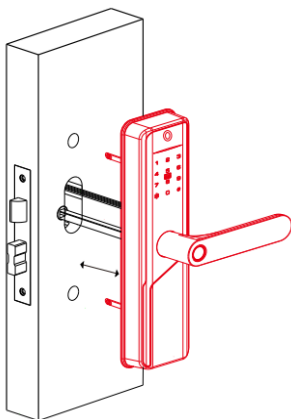

Connect the main line of the rear panel, and rear panels and install the rear panels

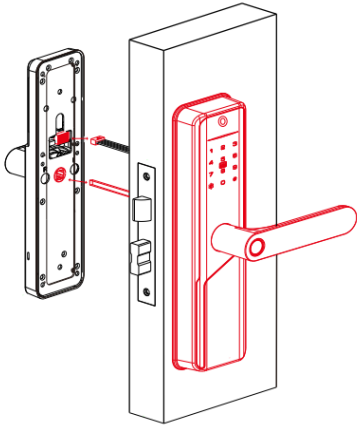

Install the connecting screws and 4X5 gauge batteries

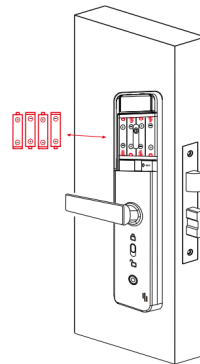
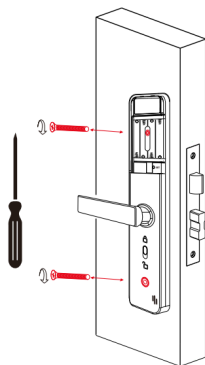

Install the battery cover, the buckle box and the gusset

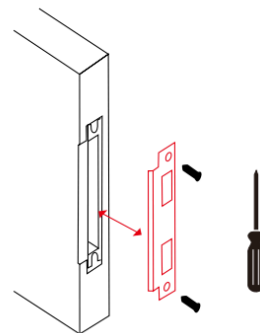
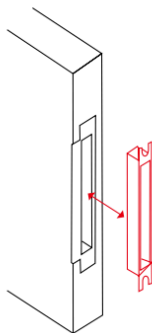
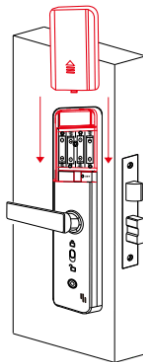

Fingerprint needs to be input from multiple angles



Function and operation

1. Administrator information: refers to the administrator's fingerprint, password or IC card.
2. Unlocking information: refers to the entered fingerprint, password or IC card information (including administrators and ordinary users).
3. "*" key: it is the clear key / back key.
4. "Key #" is the confirmation key.
5. In the initial state, any fingerprint, IC card or six digit or more passwords can be unlocked.
6. After the administrator information is entered, the fingerprint, IC card or password that is not entered cannot be unlocked.
7. Access to door lock function management.

Before entering the management menu, please press "*" + #" to enter the first group of administrator passwords.

- Press 1 for administrator settings
 - Press 1 for configuration > Press the administrator password information, fingerprint, password, card
 - Press 2 to delete > Enter the number and press # to confirm

- Press 2 for user settings
 - Press 1 for configuration > Enter the unlocking information, fingerprint, password, card
 - Press 2 to delete > Press 1 to delete the number / Press 2 to delete all
- Press 3 for system settings
 - Press 1 to time setting > Current time - modify year, month, day, hour, minute
 - Press 2 for voice selection > Press 1 for chinese and 2 for english
 - Press 3 for volume adjustment > 1 low, 2 medium, 3 high, 4 mute
 - Press 4 for normally open setting > 1 start normally open / 2 close normally open
 - Press 5 for dual authentication mode > 1 enter dual authentication mode / 2 cancel dual authentication mode
 - Press 6 for anti prying setting > 1 start / 2 close
 - Press 7 for record query
- Press 4 for networking settings
 - Start networking configuration
 - Turn off networking configuration
 - # or # send remote unlock request

Other instructions

1. If the unauthorized unlocking information is input incorrectly for more than 5 times in a row within 5 minutes, the system will automatically enter the invalid input state (locked state). Invalid input status duration is 90 seconds.
2. Password anti snooping function: when opening the door with password, enter the password as follows: XXX password XXX; You can add some irrelevant codes before and after the password, and then press # to confirm. The password must be included in what you enter.
3. The system will exit automatically if there is no operation for more than 10 seconds.
4. When the voltage is lower than 4.8V, the alarm will be given automatically every time the door is unlocked. After the alarm, the rear door lock can be unlocked 100 times. After the number is exceeded, the unlocking will be delayed for 5 seconds each time. Be sure to replace the new battery before the number of unlocking times.
5. Press and hold the set key for 6 seconds to initialize.

Technical Parameter

Quiescent current - $\leq 50\mu\text{A}$
Dynamic current - $\leq 180\text{mA}$
Number of administrators - 10 groups
Number of fingerprints - 50 groups
Fingerprint + password + card capacity - 250 groups
Rejection rate - $\leq 0.1\%$
False admission rate - $\leq 0.0001\%$
Induction time - ≤ 0.5 seconds
Power supply type - 6V
Emergency power supply - Typec 5V2A
Working temperature - $-25^{\circ}\text{C} \sim 60^{\circ}\text{C}$
Working relative humidity - $20\% \sim 90\%\text{RH}$
Keyboard - Touch the standard 12 bit keyboard
Password length - 6–10 bits
False password - 30 bits
Low voltage alarm voltage - $4.8 \pm 0.2\text{V}$

Tuya Application Networking

1. Download and install the application software "TuyaAPP" on the mobile phone (as shown in the figure)



2. Open the "TuyaAPP" location, enter the "registration" interface, and click "mobile number/email" to register the relevant account.



- After completing the registration, you will automatically enter the main interface, click "+" in Figure 1 at the top of the screen, then click "add device" in Figure 2, click "camera/lock" in Figure 3, find "WiFi" and click.

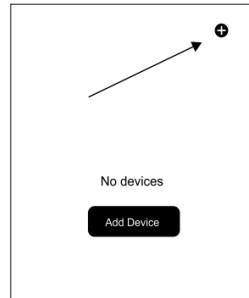

Figure1

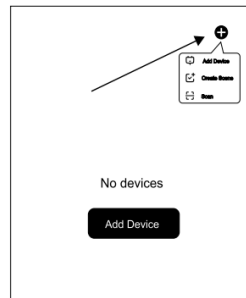

Figure2

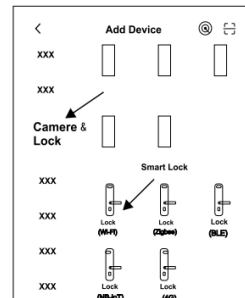

Figure3

- The page automatically jumps to the select WiFi interface. The mobile phone connects to WiFi first, selects a WiFi hotspot connected to 2.4G or a WiFi hotspot without a password, enters the "WiFi password" to connect, and then clicks "next".

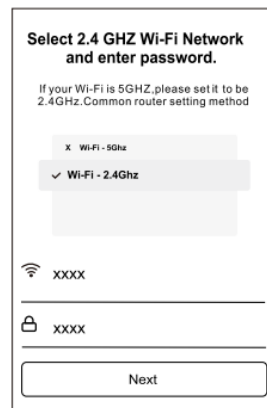
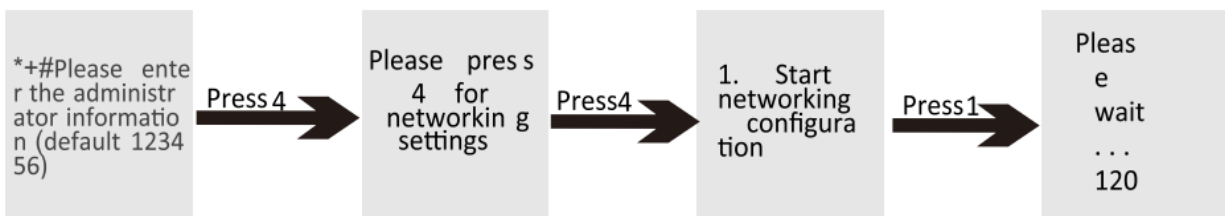

Figure1

- Lock connection network signal setting. "5" key will flash while waiting.



6. Then operate "Tuya app" and click "confirm that the keyboard light flashes".
 2. Click the Wi-Fi quick connect page to automatically jump to 3. After finding the device, automatically jump to 4. Wait for completion. After adding successfully, click "finish" to connect the device successfully.

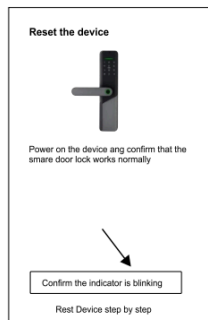

Figure1

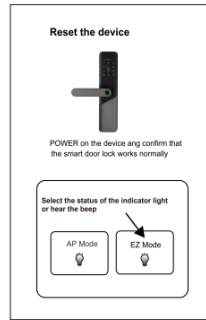

Figure2

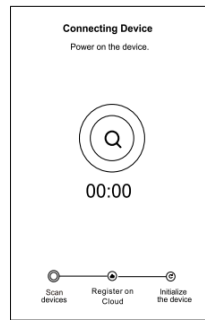

Figure3

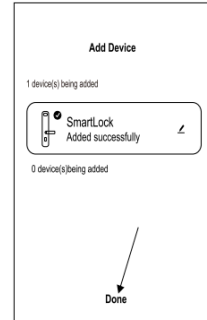

Figure4

7. After the device is successfully connected, tap the wake-up smart lock interface and press “🔔” to request unlocking. After receiving the unlocking request, the app control interface will automatically pop up "click to open the door remotely?". After confirming that it is safe

(note: After clicking the doorbell, the number 123 flashes alternately, and the remote signal is emitted. If there is no response, please click the doorbell button repeatedly)



Figure1

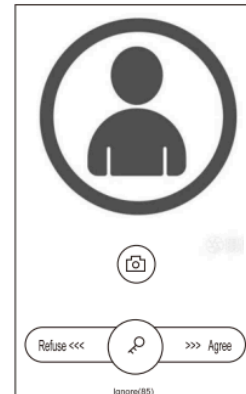

Figure2

8. Set a temporary password:

Select "Temporary Password" in the APP interface, you can choose "Online Permanent Password", "Offline One-time Password", "Permanent Password". You can choose the effective time period, enter it on the door lock after generating the password, and you can open the door lock.

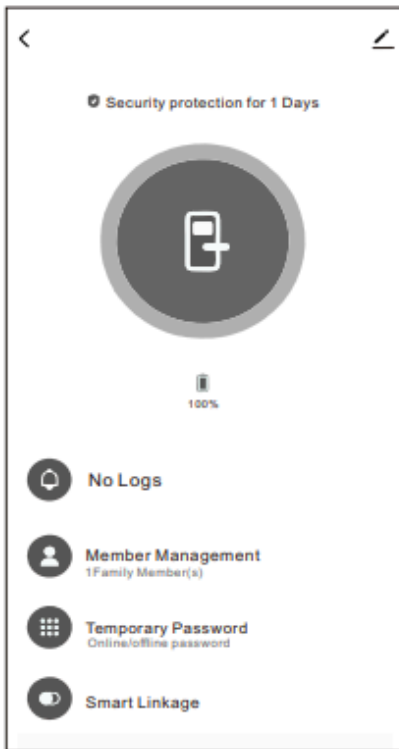

Figure1

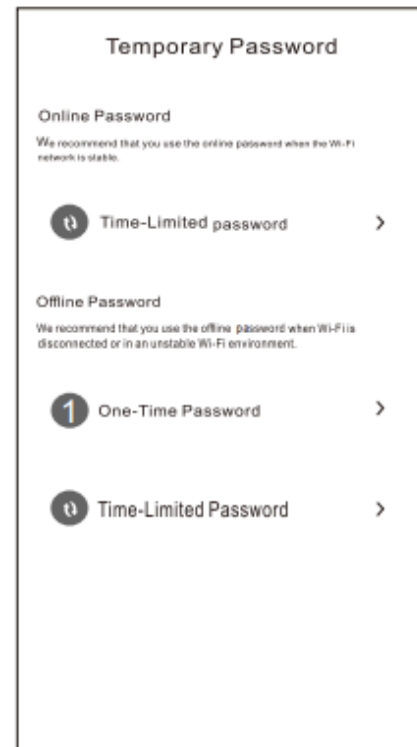

Figure2