

## **Akaso V50X 4K Action Camera with Waterproof Case - 20MP**



## Specification

Model - V50 X

LCD - 2.0-inch touchscreen

Video/Photo format - MOV/JPG

Port - USB Port / Micro HDMI Port

External Mic - Supported but sold separately.

Note: Be sure to purchase external microphones compatible with this camera

Gyroscope - 6-axis gyroscope

Battery capacity & Runtimes - 3.7V, 1350mAh battery

About 120mins of recording time in 4K.

Note: The actual battery life may vary based on the environment and usage

Remote control - Supported

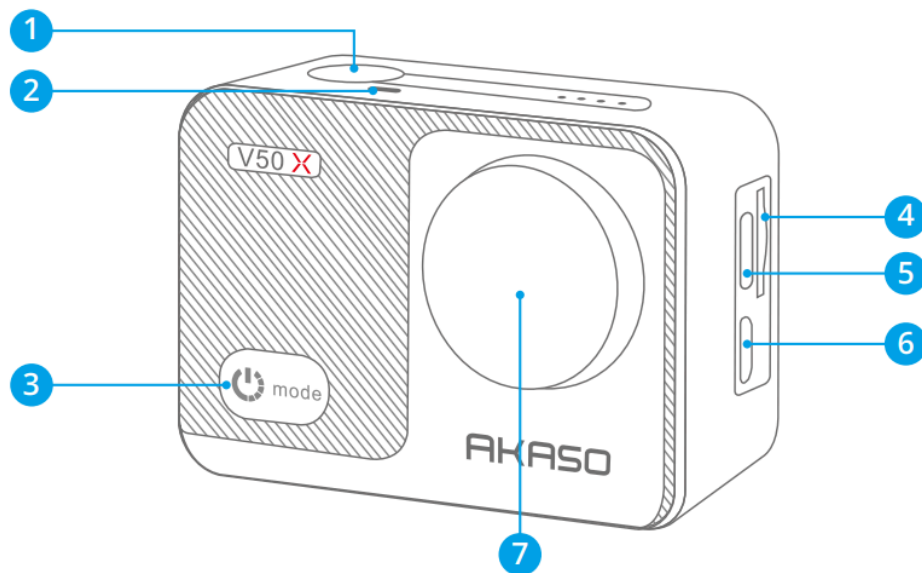

1. Shutter Button
2. Indicator Light
3. Power/Mode Button
4. Memory Card Slot
5. USB / External Mic Port
6. Micro HDMI Port
7. Lens

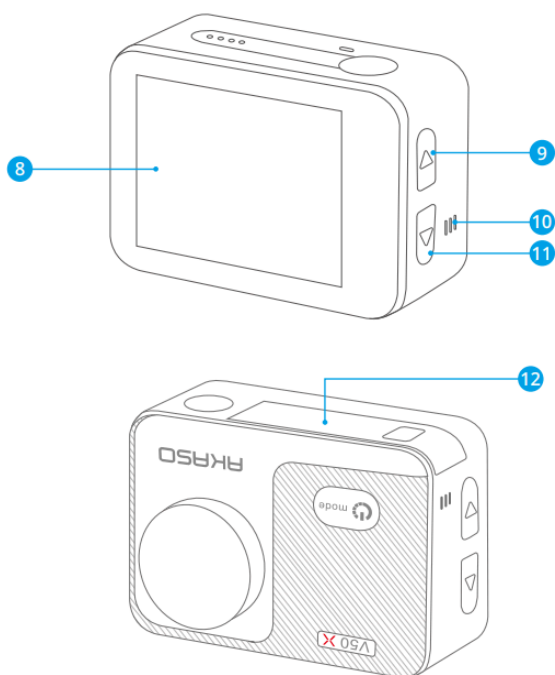

- 8. Touchscreen
- 9. Up Button
- 10. Speaker
- 11. Down Button
- 12. Battery Cover

## What's in the Box

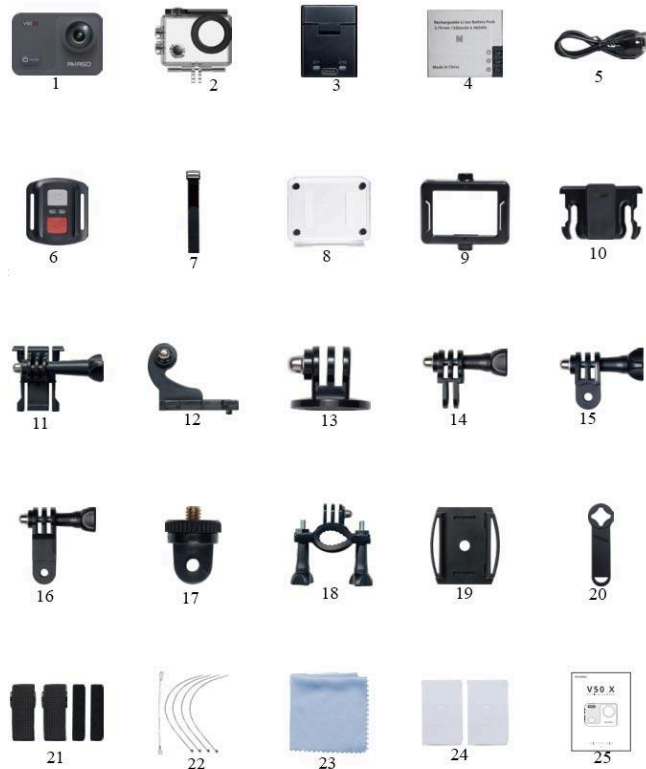

- 1. AKASO V50 X
- 2. Waterproof Housing
- 3. Battery Charger
- 4. Battery x2
- 5. USB Cable
- 6. Remote Control
- 7. Remote Control Strap
- 8. Protective Backdoor
- 9. Clip
- 10. Clip 2
- 11. Buckle Mount
- 12. J-Hook Mount
- 13. A Mount
- 14. C Mount
- 15. D Mount
- 16. F Mount
- 17. E Mount
- 18. H Mount
- 19. Helmet Mount x2
- 20. Spanner

- 21. Bandage x4
- 22. Tether x5
- 23. Lens Cloth
- 24. Double-Sided Adhesive Tape x2
- 25. Quick Start Guide

Note: The camera does not record sounds when it's in the waterproof case

To capture videos and photos, you will need a memory card (sold separately).

## Using Memory Cards

Please use brand name memory cards that meet these requirements:

- U3
- Capacity up to 256GB

1. Please format the memory card in this camera before using it for better compatibility.
2. Memory cards larger than the specified maximum capacity can cause issues like non-recognition or even camera malfunctions like unresponsiveness or firmware failure.
3. To keep your memory card in good condition, regularly reformat your memory card for optimal performance. Remember, reformatting erases all data, so transfer your photos and videos before reformatting. With FAT32, the card will stop recording and create a new file if the file size of a recording reaches 4GB.

## Formatting the memory card

1. Turn on the camera.
2. Tap the Settings icon in the bottom right corner to enter the camera settings screen.
3. Tap the Settings icon on the screen, then scroll down to locate the "Format Card" option and tap on it.
4. Select the "Confirm" option to complete the formatting process.

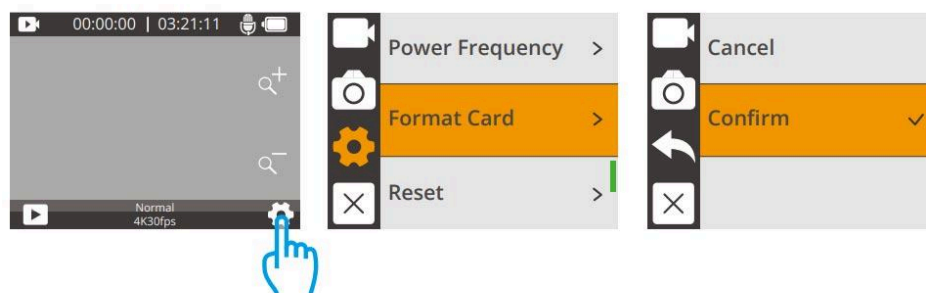

## Installing the memory card

To install the memory card, first press the battery cover to reveal the memory card slot, insert the memory card in the orientation shown, then press down on it till you hear a sound indicating it's inserted. To remove the card, press down on it again, the memory card will then pop out and make another sound.

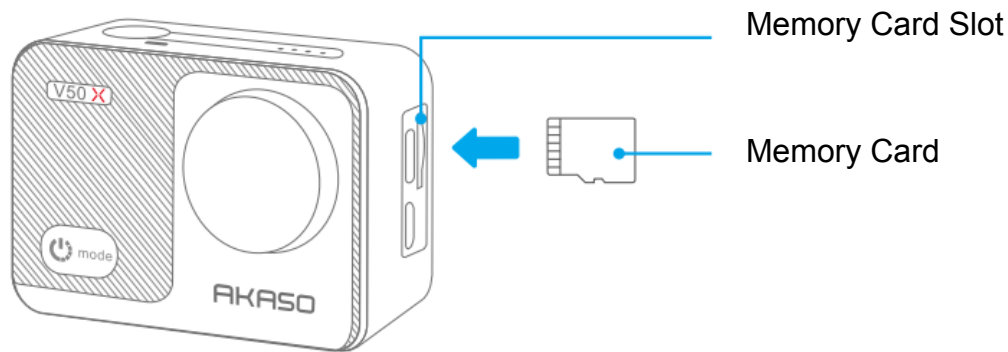

1. Be sure to turn off the camera before installation or removal.
2. Insert the card into the card slot with the correct orientation.
3. Avoid using the card in areas with strong currents or magnetic fields.
4. Refrain from allowing the card to come into contact with metal objects, and avoid using any metal tools that could cause it to be squeezed, bent, or fall.
5. Store the card in dry locations, away from corrosive substances.
6. Always ensure that no foreign items are inserted into the card slot.

## Charging the Camera

We recommend you fully charge the camera before using it for the first time.

To charge the camera, insert the battery into the camera's battery slot, connect the camera to a USB adapter or a computer using the USB cable. Once fully charged, disconnect the cable and ensure the battery cover is securely closed. You can also charge the battery separately. To do this, insert it into the battery charger, then connect the charger to a USB outlet using the USB cable.

Note: Charging your device using a computer USB port may take longer than using a power adapter, as the output of USB ports is usually lower. It will take approximately three hours to fully charge the battery, so please be patient. Once the battery is fully charged, it can last about 120 minutes of 4K video recording. Nevertheless, it's important not to overcharge the battery, so please unplug the device from the power source once it's fully charged.

## Button Operation & Indicators

Buttons/Indicator lights      /      Operation/Status

Shutter button - Press to confirm the option or start/stop video recording.

- Press and hold to access the settings menu.

Power button - Press to enter the mode menu.

- Press and hold to turn on or off the camera.

Up button - Press to turn on or off WiFi.

- Press and hold to zoom in. The camera supports up to 4X.

Down button - Press to enter the playback screen.

- Press and hold to zoom out. The camera supports up to 4X.

Status indicator - Remain blue when powering on, and go out when powering off. It will also flash when capturing photos or videos.

Charging indicator - Remain red while charging, and go out when fully charged.

Wifi indicator - Flash red when Wifi is turned on, stay on when connected, go out when Wifi is off.

## Operation Instructions

### Powering on or of

To turn on the camera, press and hold the Power button for 3 seconds. You'll hear a beep and see the status light come on. Once information appears on the display screen, you'll know that your camera is powered on.

To power off the camera, press and hold the Power button for 3 seconds. You will hear a beep and the status light will turn off.

### Turning Wifi on or of

To turn on Wifi, first turn on your camera, then press the Up button, or tap the WiFi icon in the mode menu. The camera will enter Wifi mode and display Wifi information in seconds.

To turn off Wifi, simply press the Up button again, or tap the "X" icon on the WiFi screen.

## Switching shooting modes

To switch shooting modes, first tap the mode icon at the bottom of the screen, or press the Power button to enter the mode menu. Then, tap the "Video" or "Photo" option to access the video or photo mode menu. You will be able to select the desired video or photo mode from the available options. On the mode menu, you can also press the Up or Down button followed by the Shutter button to select the mode you want.

Tip: To exit the mode menu, tap the "X" icon in the upper right corner or press the Up button.

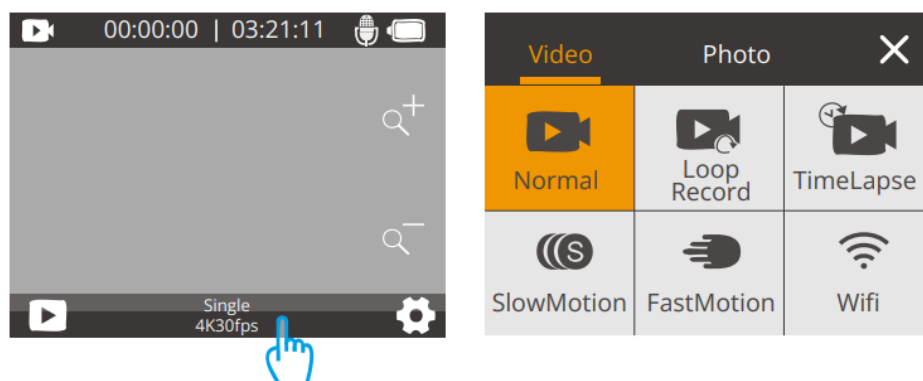

## Zooming in or out

On the preview screen, press and hold the Up or Down button, or tap the "+" or "-" icon to adjust the zoom level. V50 X action camera supports up to 4X.

## Entering the settings screen

On the preview screen, press and hold the Shutter button, or tap the Settings icon in the bottom right corner to enter the settings screen. Then, you're free to configure the photo or video, and system settings.

## Using the shutter button

In Photo or Video mode, press the Shutter button to capture photos or start video recording. To stop recording in Video mode, press the Shutter button again.

## Entering the playback screen

On the preview screen, press the Down button, or tap the Playback icon in the bottom left corner to enter the playback screen. You will be able to access the video or the photo set to playback or delete files. To exit the playback screen, simply tap the “X” icon in the upper right corner.

## Overview of Modes

There are 10 modes for the V50 X action camera: Photo, Burst photo, Time Lapse Photo, Long Exposure, Self-Timer, Video, Loop Record, Time Lapse Video, Slow Motion, and Fast Motion.

### Photo Modes

Single Photo Mode - In this mode, press the Shutter button to take a photo. The working indicator light will be flashing.

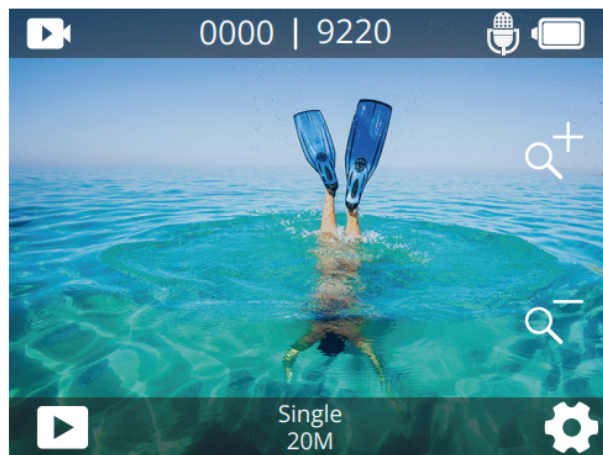

### Burst Photo Mode

In this mode, when you press the Shutter button, the camera will continuously capture photos at the set shot. This mode is ideal for capturing fast-moving scenes.

### Time Lapse Photo Mode

In this mode, when you press the Shutter button, the camera will take a series of photos at the set interval. This mode is suitable for taking photos in changeable scenes.



## Long Exposure Mode

In this mode, when you press the Shutter button, the camera will keep taking photos until the exposure time comes to the end. This mode is suitable for use in dark, light, and water scenes.

## Self-Timer Mode

In this mode, the camera takes photos at the set interval, giving a delay between pressing the shutter release and the shutter's firing. It is most commonly used to let photographers take a photo of themselves.

## Video Modes

### Normal Video Mode

The camera is in Video mode by default when turned on. In this mode, when you press the Shutter button, the camera will record video at the set resolution and frame rate. You can press and hold the Up or Down button, or press the "+" / "-" icon to adjust the zoom level. The camera supports up to 4X.

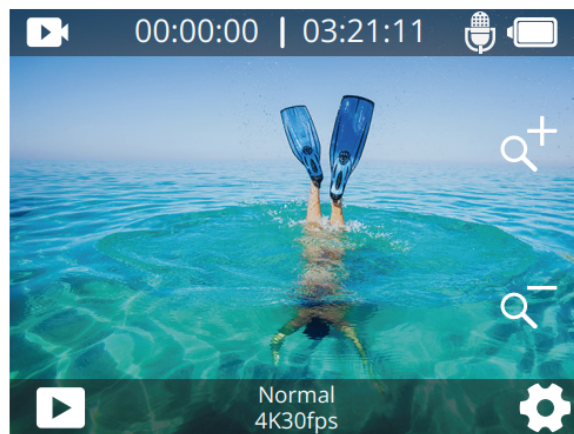

### Loop Record Mode

In this mode, when you press the Shutter button, the camera will record videos of a specific length. When the memory card is full, old files will be overwritten by new ones.

## Time Lapse Video Mode

In this mode, when you press the Shutter button, the camera will capture a sequence of video frames at the set interval to condense long events into shorter videos.

Note: Time Lapse Videos are captured without audio.

## Slow Motion Mode

In this mode, when you press the Shutter button, the camera will record videos at the set resolution and slow motion speed. However, the video footage will be saved at a playback speed of 30 frames per second (fps). As a result, when the video is played back, it will appear to be slowed down, creating a visually captivating effect.

## Fast Motion Mode

In this mode, when you press the Shutter button, the camera will capture steady and smooth fast-motion videos that appear to be moving faster than in real-time, making it ideal for use in fast-moving scenes.

## WiFi Mode

The camera Wifi works to connect the camera to the AKASO GO app to preview or transfer files. When the camera is in Wifi mode, connect your camera to the AKASO GO app. To exit Wifi mode, tap the "X" icon on the Wifi screen.

Note: The camera can't be operated when it's in Wifi mode.

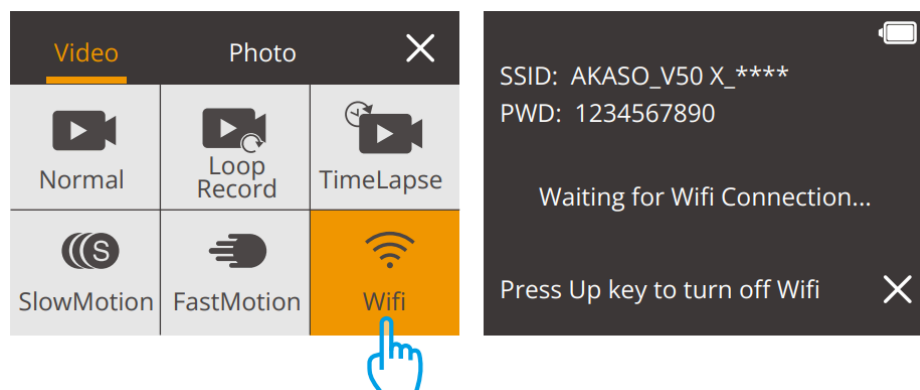

# Customizing Your V50 X

## Photo Settings

### 1. Resolution

20MP/12M/8M/5M/3M (Default setting is 20MP.)

This camera is capable of capturing 20MP photos, with higher resolution offering greater clarity and detail due to the increased number of pixels. However, higher resolution photo also results in larger file sizes.

### 2. Output Format

JPEG/JPEG+DNG (Default setting is JPEG)

This setting allows you to choose the image format you want.

### 3. Self-Timer

1 Sec/3 Sec/5 Sec/10 Sec/30 Sec (Default setting is 3 Sec.)

This option lets you specify the duration of the countdown before the camera takes a photo. The camera will initiate the timer upon pressing the shutter release button and capture a photo automatically once the countdown concludes.

Note: This option is available only in Self-Timer mode.

### 4. Time Lapse Photo

3 Sec/5 Sec/10 Sec/30 Sec/1 Min (Default setting is 3 Sec.)

This option allows you to specify the frequency at which photos are captured and compiled in Time Lapse Photo mode. The camera will take a series of photos at the set interval.

Note: This option is available only in Time Lapse Photo mode only.

### 5. Burst Photo

3 shots/5 shots/10 shots (Default setting is 3 shots.)

This option sets the number of photos to be taken in Burst mode. It's perfect for capturing fast-moving activities.

Note: This option is available only in Burst Photo mode.

## 6. Long Exposure

1Sec/2Sec/5Sec/8Sec/30Sec/60Sec ( The default setting is 1Sec.)

In this mode, when you press the Shutter button, the camera keeps taking photos until the exposure time comes to the end. This mode is suitable for use in dark, light, and water scenes.

Note: Long Exposure is available only in LongExp mode.

## 7. Exposure Value

-2/-1.7/-1.5/-1.3/-1/-0.5/-0.3/0/+0.3/+0.5/+1/+1.3/+1.5/+1.7/+2 (Default setting is 0.)

You have the option to select either a built-in microphone or an external one. To use an external microphone for better sound quality, please first choose the "External" option, then plug the compatible microphone (sold separately) into the camera's USB port.

## 8. ISO

Auto/400/800/1600/3200 (Default setting is Auto.)

ISO determines the camera's sensitivity to light and creates a trade-off between brightness and resulting image noise. Image noise refers to the degree of graininess in the image. In low light, higher ISO values result in brighter images, but with greater image noise. Lower values result in lower image noise, but darker images.

## 9. Meter

Center/Average/Spot (Default setting is Average.)

This option allows you to select the desired metering mode for different scenes.

## 10. Photo Quality

Fine/Normal/Economy (Default setting is Fine.)

This feature determines the level of detail in your photos.

## Video Settings

### 1. Resolution

4K 30fps/2.7K 30fps/2.7K 60fps/1080P 60fps/1080P 30fps/720P 120fps/720P 60fps /720P 30fps (Default setting is 4K30fps.)

This camera is capable of recording video up to 4K30fps, with higher resolution offering greater clarity and detail due to the increased number of pixels. However, higher resolution video also results in larger file sizes.

Note: When capturing videos at high resolutions or high frame rates in warm ambient temperatures, the camera may become warm and consume more power.

### 2. Image Stabilization

On/Off (Default setting is off.)

Electronic Image Stabilization (EIS) 2.0 effectively corrects the lens distortion, allowing for smooth videos. This feature is suitable for use in riding, skiing, and handheld scenes.

Note: Image Stabilization does not work together with Distortion Calibration. So it will be disabled when Distortion Calibration is enabled, and vice versa.

### 3. Loop Recording Time

1Min/3 Min/5 Min/ (Default setting is 1Min.)

This option allows you to set the length of videos captured in Loop Record mode. For instance, if you set Loop Recording Time to "3Min", the camera will save videos every 3 minutes. When the memory is full, new video files will overwrite the old ones to ensure continuous recording.

Note: Loop Recording Time is available only in Loop Record mode.

### 4. Time Lapse Interval

1 Sec/3 Sec/5 Sec/10 Sec/30 Sec/1Min (Default setting is 1 Sec)

This option enables you to specify the frequency at which the video frames are captured and compiled. The camera will capture a series of videos at the set interval, making it ideal for taking photos in dynamic or changing scenes, such as clouds, stars, sunsets, and more.

Note: Time Lapse Interval is available only in Time Lapse Video mode.

## 5. Slow Motion

2.7K 2X/1080P 2X/720P 4X/720P 2X (Default setting is 2.7K 2X)

You can choose the resolution and zoom level before recording slow motion videos. When Slow Motion is enabled, the camera can record video at a higher frame rate and then plays it back at a lower speed, typically 30 frames per second, resulting in a smoother and more dramatic effect.

Note: You can't enable Slow Motion and Image Stabilization at the same time; This option is available only in Slow Motion Video mode.

## 6. Fast Motion

2X/4X/6X/10X/15X (Default setting is 2X)

This option allows you to set the speed at which the video is sped up.

Note: Fast Motion is available only in Fast Motion Video mode.

## 7. Microphone

Built-in/External (Default setting is Built-in)

You have the option to select either a built-in microphone or an external one.

## 8. Audio Record

On/Off (Default setting is On)

You can choose to record a video with or without audio. When Audio Record is disabled, the camera will record videos without audio.

## 9. Exposure Value

-2/-1.7/-1.3/-1.0/-0.7/-0.3/0/0.3/0.7/1.0/1.3/1.7/2 (Default setting is 0)

You can set the exposure value. The larger the number, the higher the brightness. By default, your camera uses the entire image to determine the appropriate exposure level. However, Exposure lets you select an area that you want the camera to prioritize when determining exposure. This setting is particularly useful in shots where an important region might otherwise be over- or underexposed.

## 10. Meter

Center/Average/Spot (Default setting is Average)

This option allows you to select the desired metering mode for different scenes.

## System Settings

### 1. Sounds

Shutter Tone: On/Off

Boot-up Tone: On/Off

Beep Tone: On/Off

You can turn on or off the shutter, boot-up, and beep tones.

Volume: Adjust the camera's volume.

### 2. Distortion Calibration

On/Off (Default setting is Off.)

This setting corrects the fisheye effect that can occur in wide-angle shots, resulting in distortion-free images.

Note: Distortion Calibration does not work together with Image Stabilization. So it will be disabled when Image Stabilization is turned on, and vice versa.

### 3. Angle

Super Wide/Wide/Middle/Narrow

Angle refers to how much of the scene (measured by degree) can be captured by the camera lens. You can choose a desired field of view.

### 4. White Balance

Auto/Tungsten/Fluorescent/Daylight/Cloudy

White Balance captures the objects in photos with accurate color representation in various lighting conditions by adjusting the white balance, making it suitable for use in both warm and cool environments.

Note: To set White Balance, remember to set Color to "Natural".

### 5. Color

Natural/Black&White/Sepia (Default setting is Natural.)

You can choose any one of them to get a desired effect.

Note: To set Color, remember to set White Balance to "Auto".

## 6. Sharpness

Strong/Normal/Soft (Default setting is Normal.)

This setting adjusts the sharpness of your scene's elements to capture fine details, thereby enhancing the overall image or video quality.

## 7. Diving Mode

On/Off (Default setting is Off.)

When Diving Mode is enabled, the camera can compensate for the absence of red light in underwater scenes. This mode is ideal for use in tropical and blue waters.

## 8. WDR

On/Off (Default setting is Off.)

Wide Dynamic Range (WDR) retains a greater level of detail in the dark and bright areas of an image. The result is that a photo is properly exposed in the two extremes. WDR is ideal for use in high-contrast scenes.

## 9. Upside Down

On/Off (Default setting is Off.)

This setting determines the orientation of the image in videos or photos, preventing the camera from recording videos with upside-down images.

Note: The user interface will be upside-down when Upside Down is enabled.

## 10. Driving Mode

On/Off (Default setting is Off.)

In this mode, the camera will automatically record video and save the video file when you connect it to the cigarette lighter, and start your car engine.

## 11. Auto Power Off

Off/1Min/3Min/5Min/10Min (Default setting is 3Min.)

The camera will power off after a period of inactivity to save battery life.



## 12. Screen Saver

Off/30 Sec/1 Min/3 Min (Default setting is 30 Sec.)

The display will be turned off after a period of inactivity to save battery life. To turn on the display again, simply press any button on the camera or tap the screen.

## 13. Language

English/Français/ Español/ Deutsch /Italiano/ 日本語 /Português/한국인/ 简体中文 /繁体中文 (Default setting is English)

## 14. Date&Time

The default setting is MM/DD/YYYY.

You can manually set the date and time for your camera.

Tip: The camera's date and time will sync with that of your phone once it's connected to the AKASO GO app.

## 15.Date Stamp

Off/Date&Time/Date (Default setting is Date & Time.)

With Date Stamp enabled, a watermark will be added to the video or photo per your setting. You can also set it to Off.

## 16. Power Frequency

50Hz/60Hz (Default setting is 60Hz.)

Power frequency is also known as the line frequency or mains frequency, it is the frequency of the alternating current (AC) that is used in most electrical power systems around the world. If you live in the northeastern area, please set the power frequency to 60 Hz, meaning the current changes direction 60 times per second. If you live outside this area, set it to 50Hz.

## 17. Format

To keep your memory card in good condition, please reformat it on a regular basis. Reformatting erases all of your content, so be sure to offload your photos and videos first.

## 18. Reset

### Cancel/Confirm

This option resets all settings to their default values.

## 19. About

This option allows you to check the brand, model, and firmware version of your camera.

Brand: AKASO

Model: V50 X

Version: SN-AX-\*\*-\*\*-\*\*

## Connecting to the AKASO GO App

To connect your camera to the AKASO GO app, please download this app from the App Store or Google Play to your smartphone first. When your camera is connected to the AKASO GO app, you can control it to capture, or change its settings using your phone. You can also live preview, playback, download, edit, and share videos via this app. Please follow the instructions below to connect your camera to the AKASO GO app.

1. Turn on the camera, then press the Up button or tap the Wifi icon on the mode menu to turn on WiFi. The Wifi name and password will be shown on the camera screen in 3 seconds.

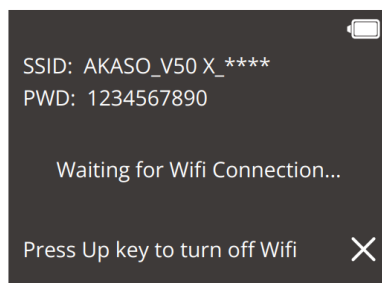

2. Turn on your phone's Wifi to enter the Wifi settings page, find the Wifi SSID in the list and tap on it, then enter the password 1234567890 for connection.

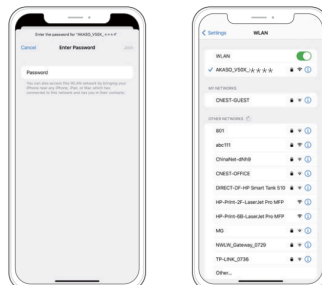

3. Open the AKASO GO app, tap “Device”→“ Add Device”, then select “V50 X” from the list for connection.

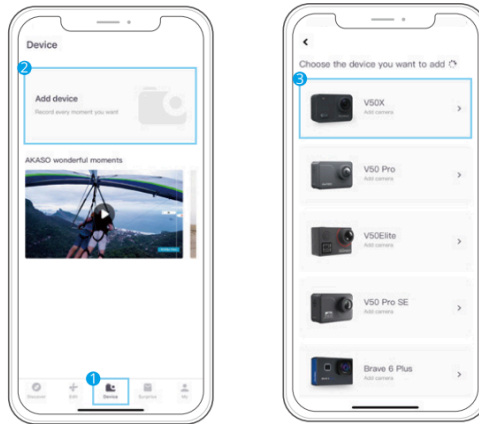

4. Tick "The above operation has been confirmed", and tap "Live Preview". Your camera will be connected to the AKASO GO app.

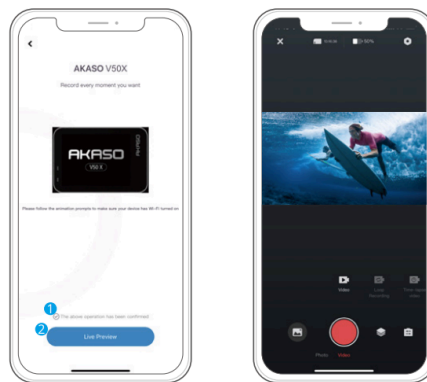

## Playing Back Your Content

You can play back your contents on the camera, your computer, TV, or smartphone. To play back your videos and photos on a computer, you need to transfer these files first. Transferring files also frees up space on your memory for new contents. With this method, the playback resolution depends on the resolution of the device and its ability to play back that resolution.

## Playing Back or Deleting Files on V50 X

On the preview screen, press the Down button or tap on the Playback icon in the bottom left corner to enter the playback screen.

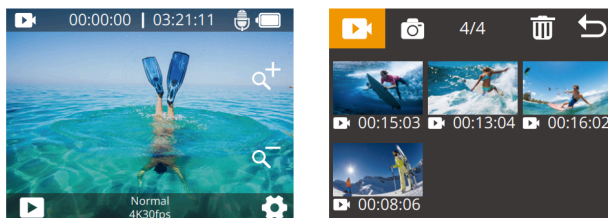

To play back files: Tap the Video or Photo icon to access the video or photo set. Select the video or photo you want to play back, and it will play.

To delete files: Tap the Delete icon  to choose the file you want to delete, then tap the Delete icon again.

To exit: Tap the Return icon  to exit.

### Playing Back or Deleting Files on the AKASO GO App

1. Open the AKASO GO app, then connect it to your camera.
2. Tap the Album icon in the bottom left corner to access all the videos and photos.

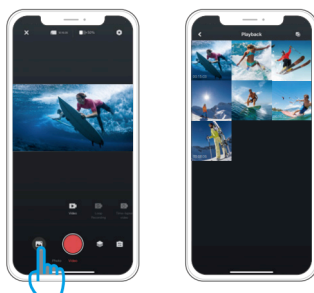

3. Choose to playback or delete files. To playback files, tap the video or photo you want to playback in full screen mode. And it will play. To delete files, tap the Select icon in the upper right corner to select files you want to delete, then tap the Delete icon in the bottom left corner followed by the Confirm option. The selected files will be deleted.

Tip: On this screen, you can also choose to download the selected file.

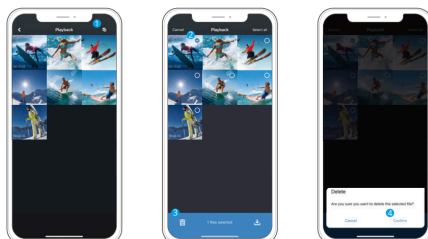

## Offloading Your Content

### Offloading Your Content to A Computer

You can transfer your content to a computer via a USB cable or a card reader (sold separately). To transfer files to your computer via a USB cable, connect your camera to the computer using the USB cable. When prompted, select “USB Storage” as your connection preference. To transfer files to the computer using a card reader, insert a memory card into the card reader, then connect the reader to your computer's USB port. After successful transmission, you can transfer the files to your computer or delete selected files using File Explorer.

### Downloading Your Content to A Smartphone

1. Open the AKASO GO app, then connect it to your camera.
2. Tap the Album icon in the bottom left corner to access all the videos and photos.

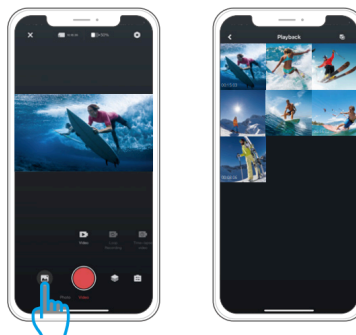

3. Tap the Select icon in the upper right corner to select the video or photo you want to download, then tap the Download icon in the bottom right corner. Patiently wait for the download process to complete. The file will be successfully saved to your phone's photo album.

Tip: On this screen, you can also choose to delete the selected file.

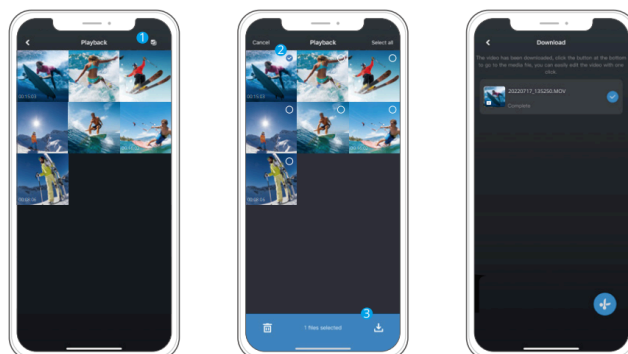

1. Please do not alter Wifi settings or disconnect from the app during the download progress.
2. If you cannot download videos or photos to your iPhone via the app, please enter your phone's Settings page → Privacy→ Photos, find "AKASO GO", and select "All photos".
3. The iPhone does not allow you to download 4K or 2.7K videos via the app. Please transfer these videos to your computer.

## Remote Control

When the camera is turned on, it will be automatically connected to the remote within a certain distance. You can control the camera to take photos or record videos using the remote.

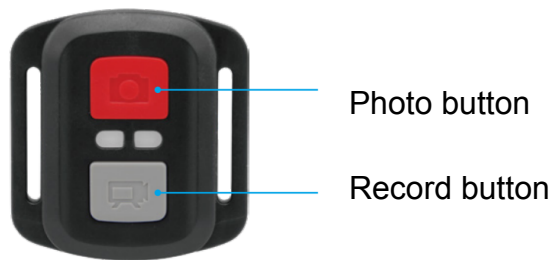

Splashproof Only, Not Waterproof

## Video

To record video, first make sure the camera is in Video mode.

To start recording, simply press the gray video button. The camera will emit one beep with the working indicator light flashing.

To stop recording, simply press the gray video button again. The camera will emit one beep with the working indicator light turned off.

## Photo

To capture a photo, first make sure the camera is in Photo mode, then press the Photo button. The camera will emit a shutter sound indicating the completion of the shot.

**Burst Photo** - To capture burst photos, first verify the camera is in Burst Photo mode, then press the Photo button. The camera will emit a shutter sound indicating the completion of the shot.

## Time Lapse

To capture time lapse photos or videos, first verify the camera is in Time Lapse mode, then press the Photo or Video button. The camera will emit a shutter sound indicating the completion of the shot.

## CR2032 Battery Replacement for Remote

1. Remove the 4 screws on the back cover of the remote with a 1.8mm Phillips tip screwdriver.



2. Remove another 4 screws on the PCB board.



3. Lift the PCB board and slide out the battery, as shown in the picture.  
Note: Do NOT rotate the PCB board to avoid reversing the camera and video button functions.



4. Install the new battery, keeping the “+” pole facing up.
5. Install all 4 screws back onto the PCB board.



6. Install all 4 screws back into the cover.

## Maintaining Your Camera

Please follow these guidelines to get the best performance from your camera:

1. For best audio performance, shake the camera or blow on the mic to remove debris from the microphone holes.
2. To clean the lens, wipe it with a soft, lint-free cloth. Do not insert foreign objects around the lens.
3. Don't touch the lens with your fingers.
4. Keep the camera away from drops and bumps, which may cause damage to the parts inside.
5. Keep the camera away from high temperature and strong sunshine to avoid being damaged.

## Maximizing Battery Life

If the battery reaches 0% while recording, the camera will save the file and power off.

To maximize battery life, follow these guidelines when possible:

- Turn off Wireless Connections.
- Capture video at lower frame rates and resolutions.
- Use the Screen Saver setting.



## Battery Storage and Operation

The camera contains sensitive components, including the battery. Avoid exposing your camera to very cold or hot temperatures. Low or high temperature conditions may temporarily shorten the battery life or cause the camera to temporarily stop working properly. Avoid dramatic changes in temperature or humidity when using the camera, as condensation may form on or within the camera.

- Do not dry the camera or battery with an external heat source such as a microwave oven or hair dryer. Damage to the camera or battery caused by contact with liquid inside the camera is not covered under the warranty.
- Do not store your battery with metal objects, such as coins, keys or necklaces. If the battery terminals contact metal objects, this may cause a fire.
- Do not make any unauthorized alterations to the camera. Doing so may compromise safety, regulatory compliance, performance, and may void the warranty.

**WARNING:** Do not drop, disassemble, open, crush, bend, deform, puncture, shred, microwave, incinerate or paint the camera or battery. Do not insert foreign objects into the battery opening on the camera. Do not use the camera or the battery if it has been damaged-for example, if cracked, punctured or harmed by water. Disassembling or puncturing the battery can cause an explosion or fire.

## Mounting Your Camera

Attach your camera to helmets, gear and equipment.

